

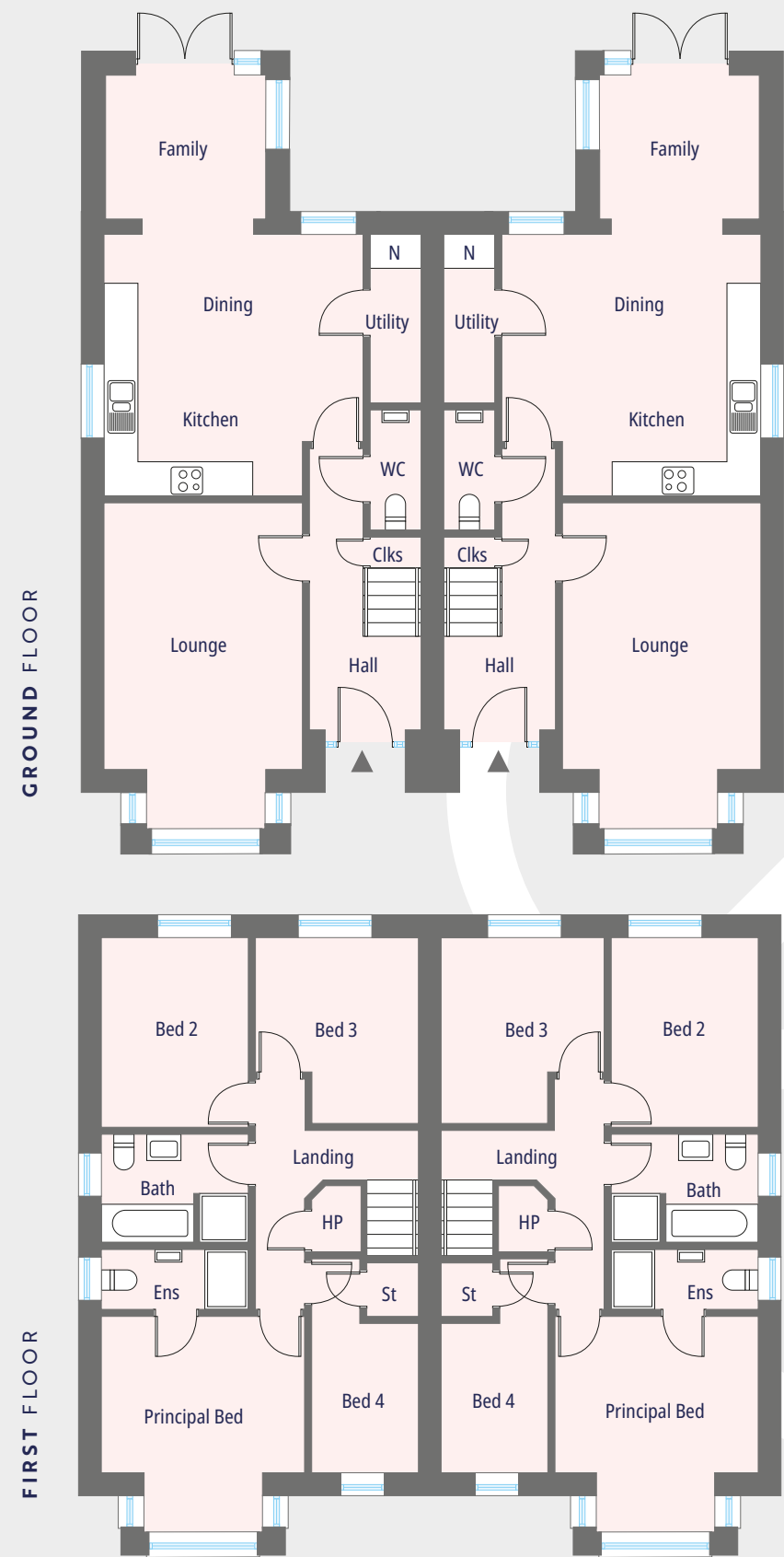

# The Staunton (D20)

4 Bedroom Semi Detached Home

Floor area: c.1362 sq ft



## GROUND FLOOR

Entrance Hall with WC and Cloakroom	
Lounge (inc bay)	
ft 19'9" x 12'2"	m 6.05 x 3.70
Kitchen   Dining (max)	
ft 15'9" x 15'8"	m 4.83 x 4.81
Family	
ft 9'9" x 9'7"	m 2.99 x 2.92
Utility	
ft 10'3" x 3'0"	m 3.12 x 0.92

## FIRST FLOOR

Principal Bedroom (inc bay)	
ft 13'2" x 12'3"	m 4.02 x 3.73
Ensuite	
ft 8'9" x 3'7"	m 2.71 x 1.10
Bedroom 2 (max)	
ft 11'6" x 8'10"	m 3.51 x 2.71
Bedroom 3 (max)	
ft 11'4" x 9'10"	m 3.44 x 3.02
Bedroom 4 (max)	
ft 13'0" x 6'6"	m 3.96 x 1.97
Bathroom	
ft 8'9" x 6'6"	m 2.71 x 1.99

**N** = Nilan Unit

**Note:** Selected sites may have a handed or rendered version. Check with our selling agents to confirm the orientation and brick/render make up of specific sites.

CGI shown for illustration purposes only. Floor plans are not to scale